



66 Homefield Road

Sileby, Loughborough, LE12 7TQ

£98,000

Berkley Estates are pleased to offer an excellent opportunity to secure a 40% share of this attractive two-bedroom semi-detached NCHA Hammond-style home. Completed in 2024 and maintained to an impeccable standard, the property presents an ideal route into homeownership for first-time buyers or those looking for an affordable, modern home. Ready to move straight into, it offers comfortable, contemporary living throughout.

LOCATION

The property is situated in the well-served Charnwood village of Sileby, centred around a traditional village hub with a wide range of amenities including popular pubs, independent shops, and everyday conveniences. Its location provides swift connections to Loughborough, Leicester, and the M1 at Markfield, making it perfect for commuters. Nearby natural attractions include Swithland Reservoir and the renowned Bradgate Park, offering beautiful outdoor spaces close at hand.

GROUND FLOOR

A welcoming entrance hallway greets you on arrival, complete with wood-effect flooring and generous room for coats and footwear. From here, you can access the downstairs WC, the

Viewing

Please contact our Berkley Leicester Office on 0116 2544755 if you wish to arrange a viewing appointment for this property or require further information.

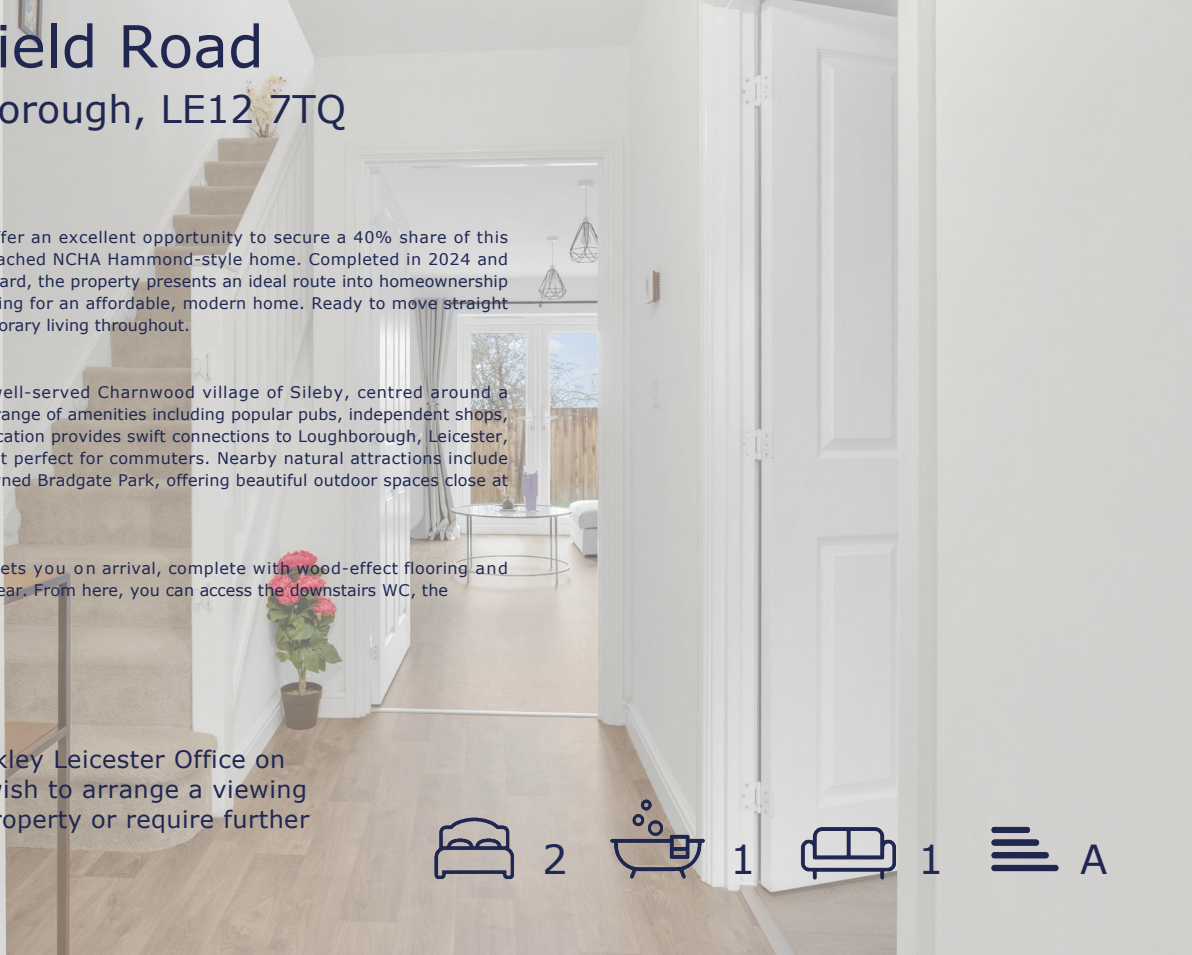

2 1 1 A

Floor Plan

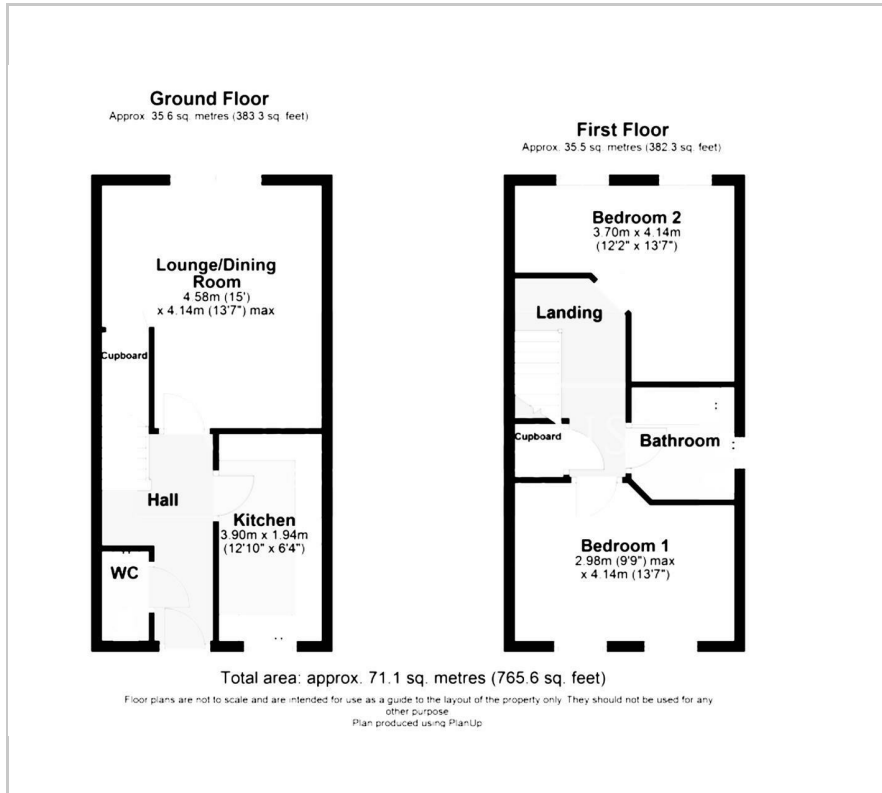

Area Map



Energy Efficiency Graph

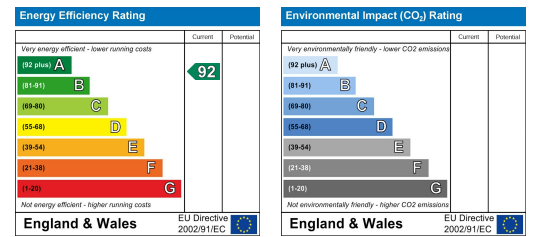

These particulars, whilst believed to be accurate are set out as a general outline only for guidance and do not constitute any part of an offer or contract. Intending purchasers should not rely on them as statements of representation of fact, but must satisfy themselves by inspection or otherwise as to their accuracy. No person in this firm's employment has the authority to make or give any representation or warranty in respect of the property.